



# INSTALLATION INSTRUCTIONS

## D-SERIES WORM DRIVE DAYLITER DUAL SHADE



\*\* PLEASE READ ENTIRE INSTALLATION INSTRUCTIONS BEFORE ASSEMBLING THE PRODUCT

### SUGGESTED TOOLS

DRILL  
LEVEL  
PENCIL  
SCREWDRIVER  
TAPE MEASURE

---

## I. MOUNTING OPTIONS & INFORMATION

INSIDE MOUNT – Dayliter Shade is mounted to the structural jamb inside the window opening

FRONT MOUNT – Dayliter Shade is mounted to the window frame or front of the window mullion

### NOTE:

Mounting screws provided are suitable for most mounting surfaces (*Please see below for additional notes*)

WALLBOARD OR PLASTER – Use hollow wall anchors for added support

CONCRETE, STONE, BRICK, OR TILE – Use appropriate drill bit and anchors before fastening the screws

METAL SURFACES – Pre-Drill holes before fastening the screws

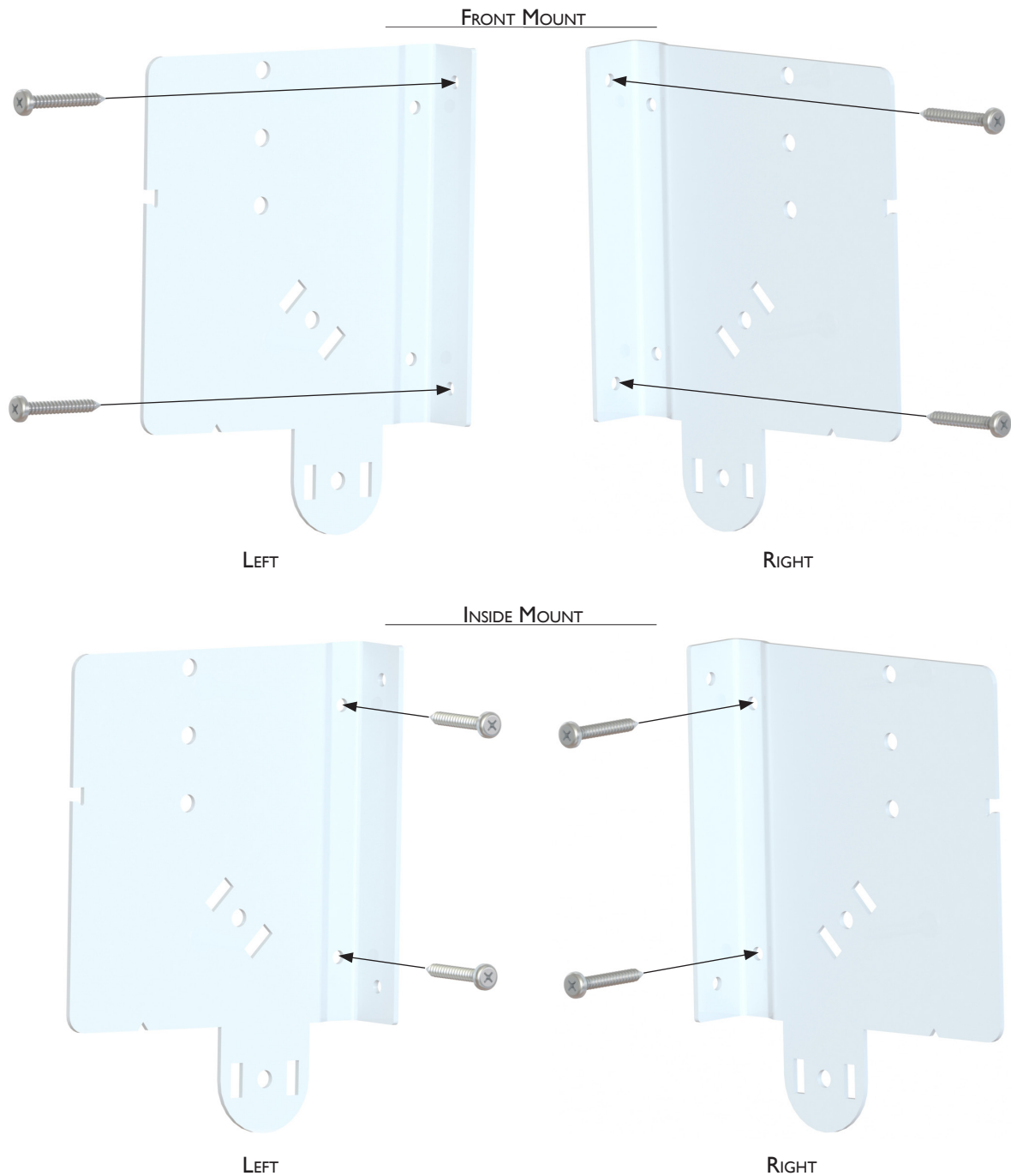

---

## 2. MOUNTING BRACKET LOCATION

USING THE TEMPLATE PROVIDED – Mark the location of the holes to be drilled for the mounting brackets  
(The template will indicate whether the brackets are to be inside or front mounted)

ATTACH BRACKETS – Using supplied hardware – Use level to ensure brackets are vertical before tightening

### IMPORTANT:

TO ENSURE THE SHADE OPERATES CORRECTLY – Make sure the head of the window opening is relatively straight and level prior to using the template  
– IT IS CRITICAL THAT THE BRACKETS ARE LEVEL



**NOTE:** Template should be positioned on the jamb for inside mount

## 3. INSTALL ROLLER SHADES

WITH SHADE ROLLED ALL THE WAY UP – The pin end snaps into the hole on right side then the clutch slots are inserted on the left  
(or vice versa, depending on clutch installation)

– The clutch should be installed on the side best suited to the room layout (or user preference)

**IMPORTANT:** BE SURE TO INSTALL THE BACK SHADE FIRST

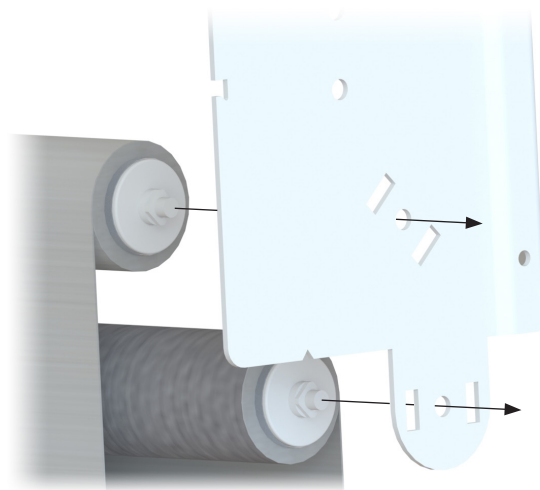

---

#### 4. ROLLER CLUTCH – CHAIN INSTALLATION

ATTACH SAFETY CHAIN HOLD to either Frame or Jamb – Ensure roller shade operates freely using chain operator

INSTALL OPTIONAL CHAIN STOPS with shade in closed position (*all the way down*) – Prevents shade tube from being exposed by over rotation

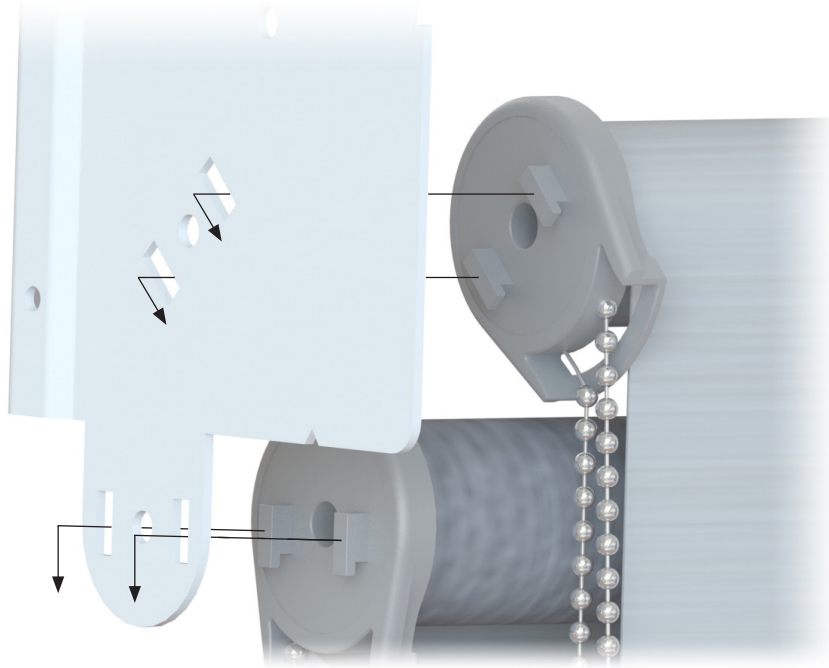

#### 5. INSTALL LIGHTSHELF

INSERT SQUARE DRIVE PIN into square receiver in worm gear

WITH PIN END DEPRESSED slide square opening, in light shelf, over drive pin

(*this may take some maneuvering of the light shelf to get it into a position to slide together*)

WHEN DRIVE PIN is fully engaged – SNAP PIN END into hole in bracket

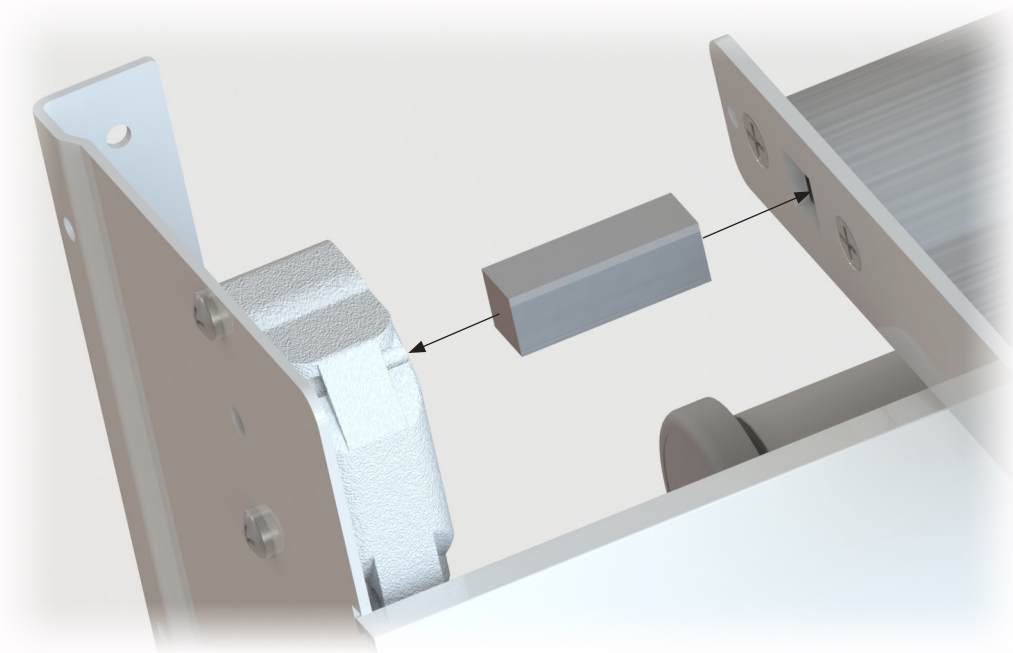

---

## 6. FOLDING CRANK INSTALLATION

SLIDE UNIVERSAL END OF FOLDING CRANK in the input shaft – connect using safety clip

ATTACH FOLDING CRANK RETENTION CLIP to jamb with screws provided so that crank will hang straight and snap into clip

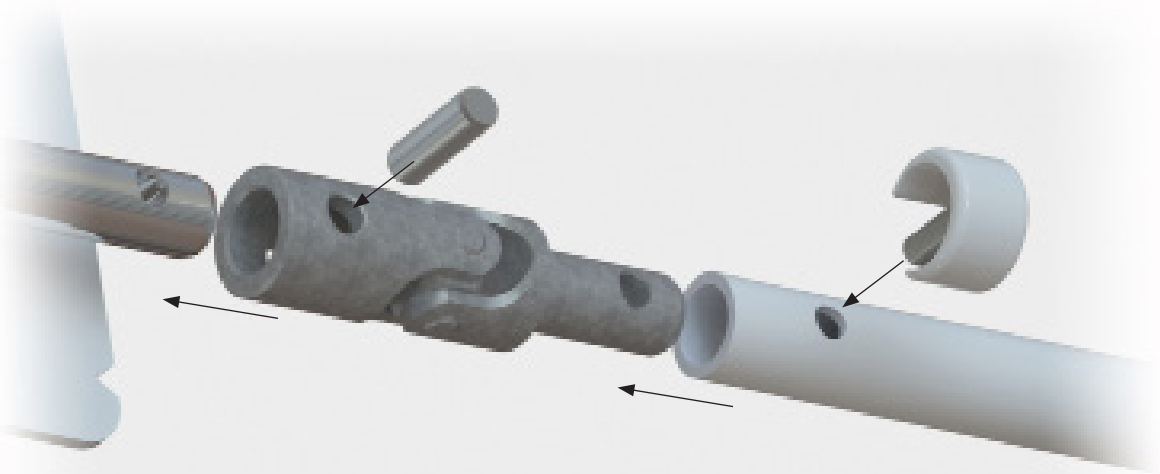

## 7. FASCIA INSTALLATION

SNAP FASCIA IN PLACE on brackets by inserting top edge and rotating bottom until it snaps in place

**NOTE:**

MAKE SURE CRANK AND WORM GEAR OPERATE FREELY AND LIGHT SHELF ROTATES OPEN AND CLOSED FREELY

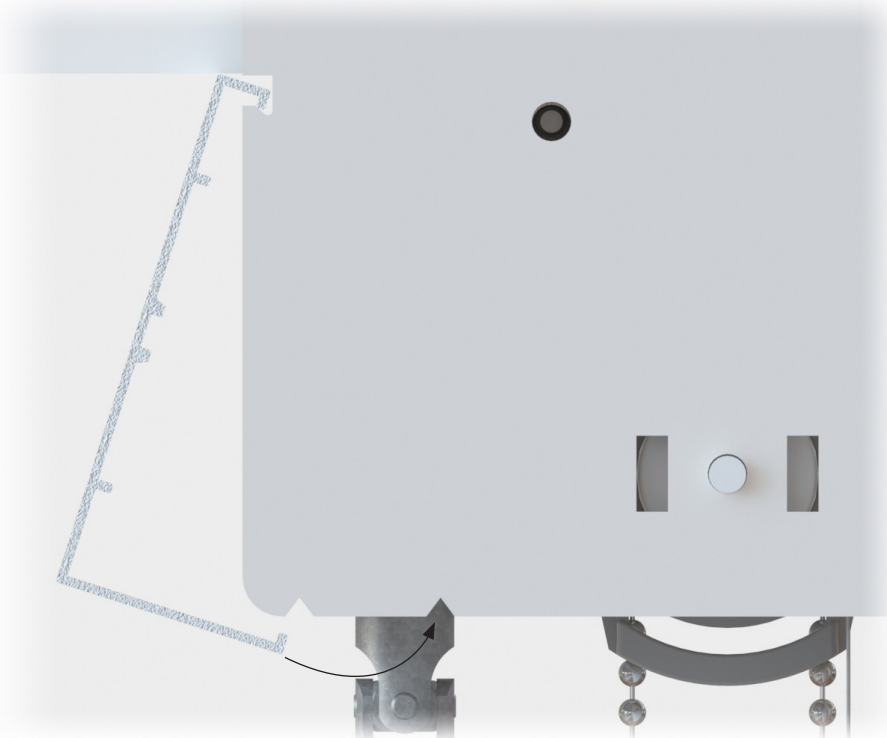

---

## SINGLE SHADE APPLICATION



## MULTIPLE SHADE APPLICATION

